

GENERAL NOTES:

- NOT USED
- SEE STRUCTURAL DWG'S FOR CONC. FLOOR PIT DETAILS. REFER TO PLANS FROM REFRIGERATION VENDORS FOR A DIMENSIONED LAYOUT OF PITS. VENDORS PLANS ARE INCLUDED IN THIS SET OF DOCUMENTS.
- ALL NEW EXTERIOR MASONRY WALLS TO BE INSULATED WITH FOAM-IN-PLACE INSULATION (SEE SPECS.).
- ALL INTERIOR DRYWALL PARTITIONS TO BE 2x4 STEEL STUDS AT 16" O/C UNLESS OTHERWISE NOTED ON PLANS - SEE NOTE #4 BELOW.
- NO CONSTRUCTION FLOOR JOISTS (FORCED OR SAVED) SHALL BE IN FLOOR OF NEW PRODUCE PREPARATION (07), OR NEW BAKERY (25).
- NOT USED
- ALL PENETRATIONS IN THE WALL, CEILING, ETC., FROM PLUMBING LINES, HVAC DUCTWORK, ELECTRICAL CONDUIT, ETC., SHALL BE SEALED WITH THE APPROPRIATE FIRE SEALANT OR CAULKING.
- TOILETS, FOOD PREP, AREAS, MEAT COOLER AND SEAFOOD COOLER SHALL HAVE FLOOR SLOPED TO FLOOR DRAINS. TRENCH DRAINS (SEE SPECS.). REFER TO PLUMBING DWG'S FOR LOCATION OF DRAINS.
- INDICATES PARTITION TYPE. SEE SHEET A-4 FOR SECTIONS AND DESCRIPTION OF EACH TYPE. ALL PARTITIONS ARE TYPE 1 UNLESS OTHERWISE NOTED.
- ALL ELECTRICAL DEVICES (e.g. SWITCHES, OUTLETS, ETC.) SHALL BE LOCATED ON 2x4 SMOOTH FACE BLOCK - CENTER DEVICE ON SPACE, UNLESS OTHERWISE NOTED. SEE DETAIL ON ELEC. DWG.
- F.E. FIRE EXTINGUISHER.
- INSTALL 4'-0" HIGH x 3'-0" EXT. PLYWOOD ALONG W/ A 2x12 TREATED BASE ON ALL WALLS OF EXISTING STOCKROOMS (08 & 117).
- IN NEW DINING AREA (121), AND NEW VIDEO RENTAL (106) INSTALL BLOCKING IN MALL TO SUPPORT A WALL HUNG TELEVISION. VERIFY EXACT LOCATION WITH TENANT.

EXPANSION / CONTROL JOINT LEGEND

- C.J. CONTROL JOINT SHEETROCK ONLY
- S.L. CONTROL JOINT FROM BOTTOM OF LINTEL UP
- C.J. CONTROL JOINT
- E.J. 1" EXPANSION JOINT W/ 2 LAYERS 1/2" ASPHALT JOINT MATERIAL

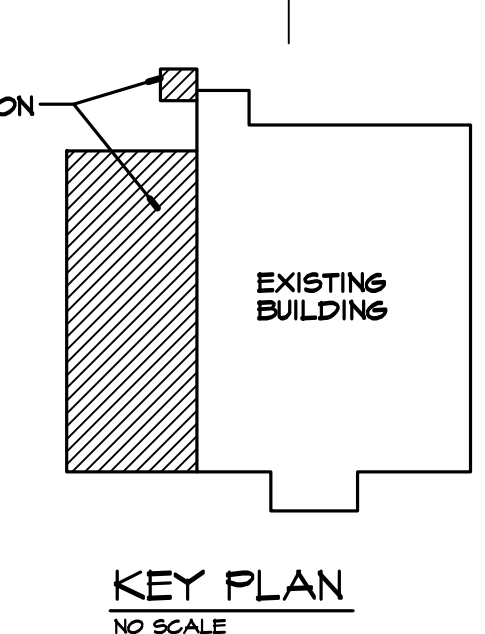
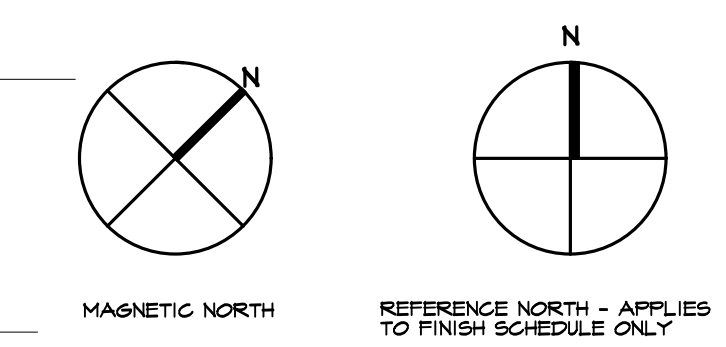

FLOOR PLAN
SCALE: 1/8" = 1'-0"

These documents prepared by the Architect are instruments of the Architect's service. They shall remain the property of the Architect and shall not be reproduced, copied, or disseminated in any form or by any means without the prior written consent of the Architect. The Architect's liability shall be limited to the maximum extent permitted by law.

p.o. box 1177
greenville, tn. 37744
(423) 638-1616



matin concepts, inc.

revisions by

project

drn. by: TLR

app. by: JRS

date: 12/22/00

sheet no. **A-1**

ADDITIONS AND RENOVATIONS TO
FOOD CITY STORE # 678
WESTERN AVENUE - KNOXVILLE, TENNESSEE
FOR
K.V.A.T. FOOD STORES, INC.
ABINGDON, VIRGINIA